

Sample and Vent Valves



The Sample and Vent valves for stainless steel filter housings are engineered for cleanliness and ease of use. The valves are constructed of 316L stainless steel for excellent resistance to corrosive chemicals and to ensure product purity. They are machined to a < 25Ra, finish.

The valves come in both In-Line and 90 degree models. Additional assemblies comes with a pressure gauge, Tee fitting and valve for ease of use. The output fitting on the valve is a hose barb to make quick attachments with a hose to vent or take samples. The design of the unit minimizes dead space for possible contamination build up between usage. The valve has a limited stem travel for safety and valve protection. The knob is made out of Delrin® from DuPont, which is a durable low wear, low friction plastic ideal for this application.

The valve provides for a compact design that his easy to utilize on a day to day application



Applications	
Filter Housings	Tanks
Pressure Vessels	Day Tanks

Materials of Construction

- Body: 316L Stainless Steel
- Knob: Solid Delrin Knob
- O-Rings: Silicone, Teflon (optional)

Connections - Offset

- Inlet: 1/2" Ferrule, 1/4" NPT, 1/2" Weld
- Outlet: 1/4" Hose Barb

Finish

- Machined <25Ra

Operating Conditions

- Max operating pressure: 200 psi (13.8Bar) @200F (93C)
- Test Pressure : 165psi (11.4 Bar)@75F (24C)

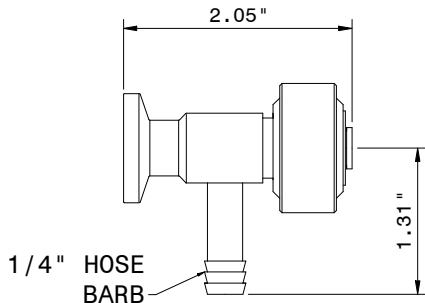

90° 1/2" FERRULE
P/N OFSV90F

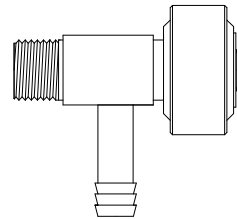

90° 1/4" NPT
P/N OFSV90N

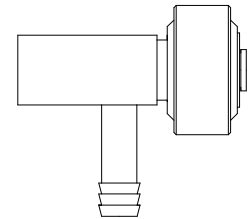

90° 1/2" WELD
P/N OFSV90W

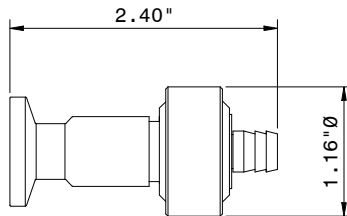

IN-LINE 1/2" FERRULE
P/N OFSVILF

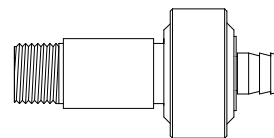

IN-LINE 1/4" NPT
P/N OFSVILN

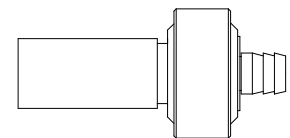

IN-LINE WELD
P/N OFSVILW

Sample and Vent Valves

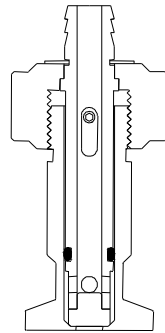

Cross section of a sanitary sample valve, showing the internal workings

Additional Assembly Options

Industrial Pressure Gauge and Vent Valve Assembly

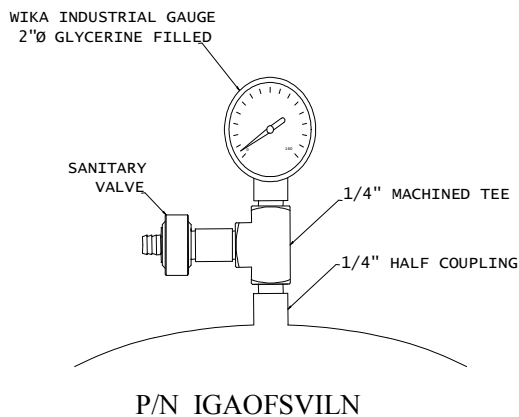

- 100-160 PSI Pressure Gauge
- 316L Stainless Steel
- Sanitary Vent/Sample Valve
- Machined 1/4" NPT Tee

Sanitary Pressure Gauge and Vent Valve Assembly

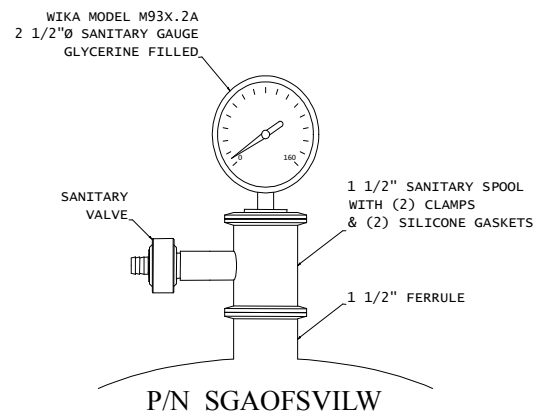

- 100-160 PSI Pressure Gauge
- 316L Stainless Steel
- Sanitary Vent/Sample Valve
- 1 1/2" Electropolished Tri-Clamp Spool
- (2) Silicone Gaskets & (2) SS Clamps

Your Local Distributor:

Please Visit Us At:

www.jalttechnologies.com

P.O. Box 597

Manassas, VA 20108

703-335-9910

JALT Technologies is a registered trademark of JALT Technologies, LLC. Copyright 2005. All rights reserved. Viton is a registered trademark of DuPont Dow Elastomers. Delrin is a registered trademark of DuPont. Wika is a registered trademark of Wika Instrument Corp.